

# Orientalmotor

## Flange Drive Adapter

Permissible load has been increased by mounting with a parallel shaft gearhead. Direct mounting of the rotation mechanism to wheels or rotary tables has been simplified, which helps reduce design time.



Flange Drive Adapter  
**AGD580B**  
List Price: \$552.00

Increased  
Permissible  
Load

### Compatible Motors

Brushless Motors  
Parallel Shaft Gearhead  
100 W (1/8 HP)/120 W (1/6 HP)

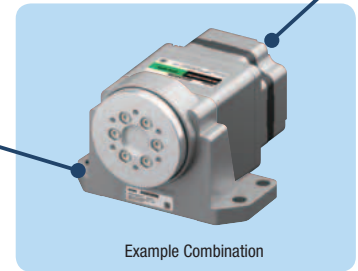

### Greatly Increased Permissible Load

High permissible load is achieved by adopting a cross-roller bearing. Large increases to the permissible radial load and permissible axial load allow for the capability of handling of loads larger than with the gearhead alone.

#### Flange Drive Adapter

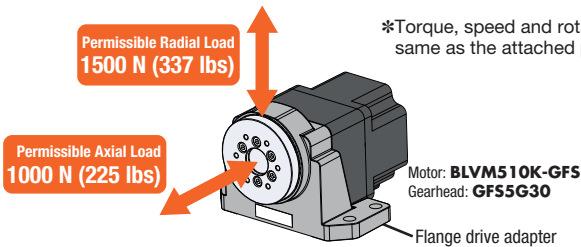

#### Only Parallel Shaft Gearhead

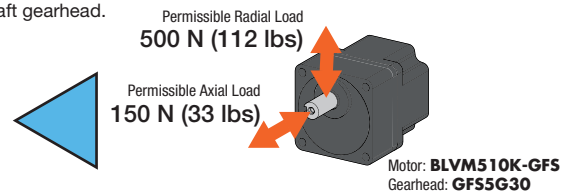

### Simplified Design

Thanks to the integration with cross-roller bearings, load attachment tables, etc., the time to arrange extra parts and mechanism design is reduced. Installation work is also simplified because they can be attached directly to the load shaft or directly to the enclosure.

#### Example) Unmanned Carrier

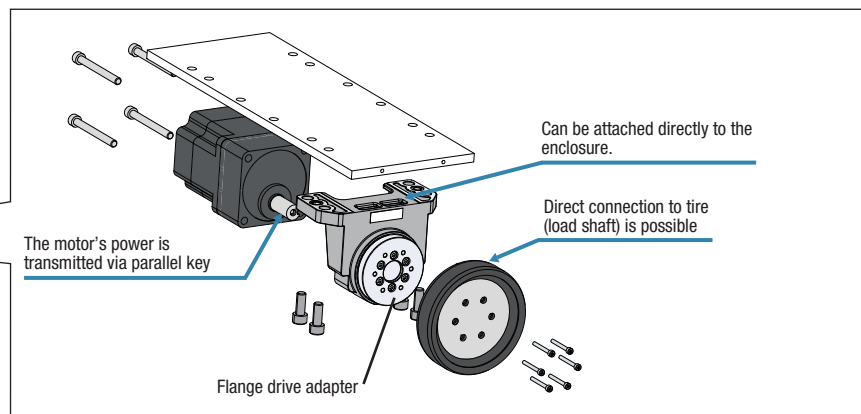
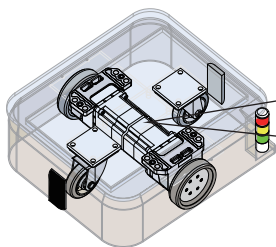

### Heavy Object Rotation Applications Recommended for Driving Unmanned Carriers and Rotary Tables

The increased permissible load makes transportation of heavy objects possible for unmanned carriers and rotary tables.

#### Example) Unmanned Carrier

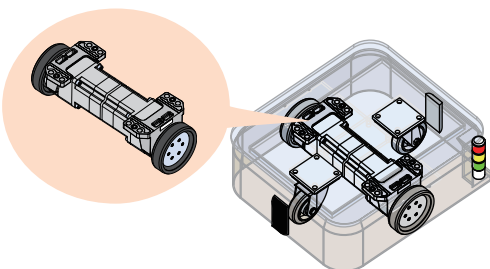

#### Example) Rotary Table

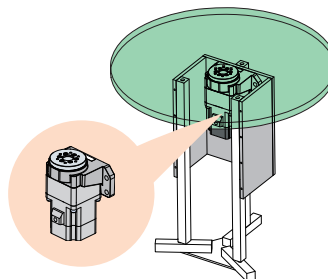

#### Example) Arm Drive

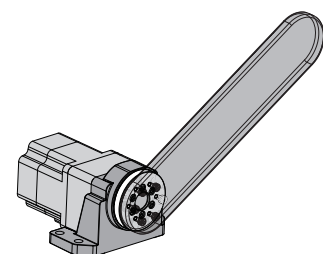

## Product Line

Product Name	List Price	Applicable Product		
		Gearhead	Series	Output
<b>AGD580B</b>	\$552.00	Parallel Shaft Gearhead	<b>BMU</b> Series, <b>BLE2</b> Series, <b>BXII</b> Series	120 W (1/6 HP)
			<b>BLV</b> Series <b>R</b> Type, <b>BLV</b> Series, <b>BLH</b> Series	100 W (1/8 HP)

## Specifications

### Specifications

Item	Specifications	
Max. Speed [r/min]	1000 (225)	
Rotation Direction	Same direction as gearhead	
Permissible Radial Load (mounting surface) [N]	Up to 300 r/min	1500 (337)
	Over 300 r/min	1000 (225)
Permissible Axial Load [N]	Up to 150 r/min	1000 (225)
	Over 150 r/min	500 (112)
Internal inertia J* [ $\times 10^{-4}$ kg·m <sup>2</sup> ] (oz·in <sup>2</sup> )	4.38 (24)	

\*Select by adding the mechanism's inertia to the internal inertia of the flange drive adapter.

● For the specifications of the compatible motors, please check the Oriental Motor website.

### Speed – Internal Load Characteristics (Reference values)

The internal load of the flange drive adapter can vary depending on the operating ambient temperature, increasing the load applied to the motor and gearhead.

Select motor and gearhead carefully when using in low temperature environments.

#### AGD580B

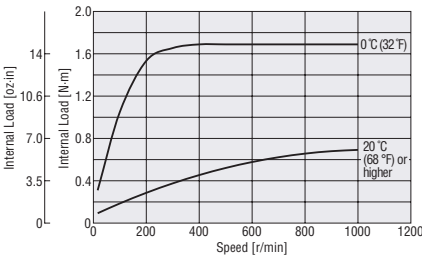

Example) When using at 200 r/min at an ambient temperature of 0 °C (32 °F), add 1.6 N·m (14.16 lb·in) to the mechanism's load torque and select the appropriate motor and gearhead.

#### Note

Data for the speed – internal load characteristics is based on Oriental Motor's internal measurement conditions.

If conditions such as ambient temperature are changed, the characteristics may also change as a result.

Internal load decreases due to conformability, so do not use as holding force.

### Dimensions Unit = mm (in.)

Mass: 1.6 kg (3.53 lb.)

2D CAD A1805

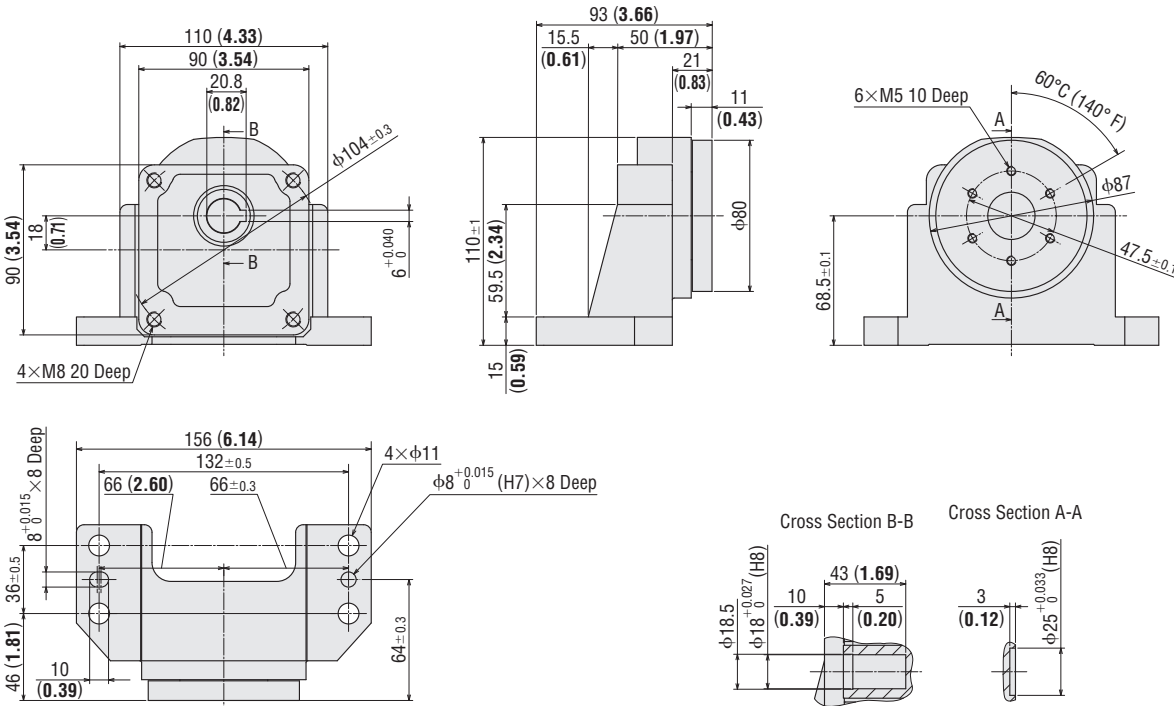

**ORIENTAL MOTOR U.S.A. CORP.**

Technical Support Tel: 800-468-3982 7:30A.M. - 7:00P.M. C.S.T (M-F) E-mail: techsupport@orientalmotor.com